

ES-4T-LE SPECIFICATIONS

Driver Type: 4" Dual Cone (with whizzer HF)
Power Rating: 25 watts (EIA Standard 426B)
Frequency Response: 67Hz – 20kHz ± 6dB
Sensitivity: 84.3 dB SPL (8Ω, 1W@1M)
Dispersion: 135° conical (-6dB @ 2kHz octave)
Available Transformer Taps: 100V (16W, 8W, 4W, 2W taps), 70V (16W, 8W, 4W, 2W, 1W taps), 25V (2W, 1W, .5W, .25W, .13W taps)



ES-62T-LE SPECIFICATIONS

Driver Type: 6-1/2" Coaxial
Power Rating: 50 watts (EIA Standard 426B)
Frequency Response: 50Hz – 20kHz ± 6dB
Sensitivity: 87.9 dB SPL (8Ω, 1W@1M)
Dispersion: 120° conical (-6dB @ 2kHz octave)
Available Transformer Taps: 100V (32W, 16W, 8W, 4.2W taps), 70V (32W, 16W, 8W, 4W, 2W taps), 25V (4.4W, 2.2W, 1.1W, .55W, .28W taps)



GENERAL SIGNALING
EQUIPMENT



LISTED
4M24

UL1480 5th EDITION GENERAL SIGNALING
CSA C22.2 NO. 205-M1983, UL2043
SUITABLE FOR USE IN PLENUM SPACES

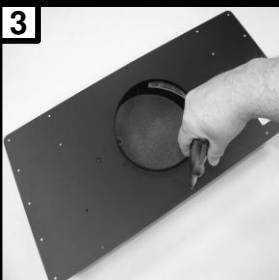

Mounting Note: The speaker system must be mounted in accordance with local, state, and federal codes and regulations, and industry standard practices. The 4" speaker model and accessories are shown in all pictures, but the pictures and instructions are also applicable to the 6-1/2" speaker model and accessories.

Installation in New Drywall (Sheetrock) Ceiling

On a construction project with a new drywall ceiling where the cable will run in flexible or fixed conduit, a speaker rough-in bridge and enclosure must be installed before the drywall ceiling is installed. The ES-4T-LE and ES-62T-LE speaker systems (that do not include enclosures) are sold separately so that the rough-in bridge and enclosure accessory can be installed before the drywall ceiling is installed, and the speaker system can then be installed at a later date after the drywall ceiling is in place and has been painted.

Rough-in for ES-4T-LE Speaker System

1 The ES-4-RIB rough-in bridge (sold separately) includes mounting holes on twenty-four (24) inch centers and sixteen (16) inch centers for mounting to the joists, rafters, trusses, metal rails, or other ceiling support structure. Screw types required to mount the bridge vary widely depending on the construction of the ceiling structure so **mounting screws are not included and will be supplied by the installer.**

2 The ES-8XD4 enclosure (sold separately) includes 4) 8-32 X 0.75" bolts.

3 To prepare the rough-in assembly, position the ES-8XD4 enclosure on a work surface with the bolting holes facing upward. Place the ES-4-RIB bridge on top of the ES-8XD4 enclosure with the lip facing upward and with the 4 Tinnerman clips on the enclosure lined up with the 4 holes in the bridge. Use the 4) 8-32 X 0.75" bolts (that were supplied with the enclosure) to attach the bridge to the enclosure as shown.

4 Mount the ES-4-RIB/ES-8XD4 bridge/enclosure assembly to the ceiling structure with the lip downward toward the floor. Attach conduit to one or more of the four (4) combination 1/2"-3/4" knockouts that are available on the enclosure and install speaker cable as required. When the ceiling contractor installs the drywall, the lip will be used as a router guide to cut-out the hole in the ceiling at the location that you have predetermined by mounting the rough-in bridge.

5 The same procedure described above would be used to rough in for the ES-62T-LE speaker system using the ES-6-RIB rough-in bridge and the ES-CP84 enclosure assembled as shown.

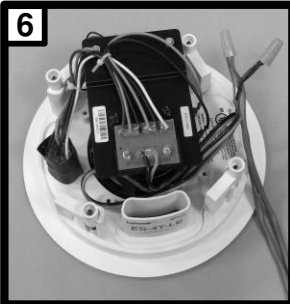

6 After the drywall ceiling has been installed and painted.

6 Two (2) input pigtails (“-“ black wire and “+” red wire) are available to be spliced to the input wiring to the speaker and output wiring to the next speaker in the string. Wire nuts are provided to make the splice connections to the pigtails.

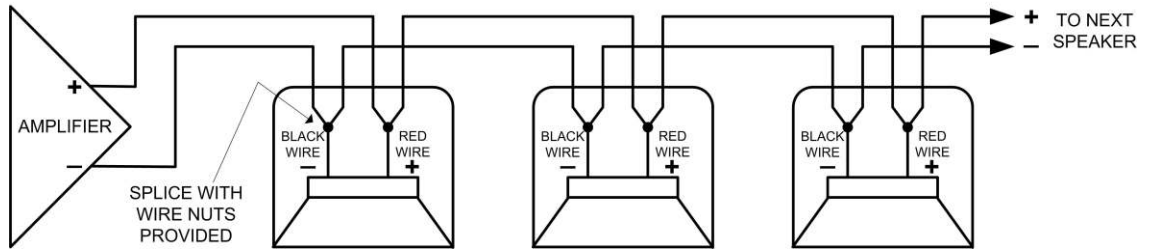

For use in a speaker system without using the internal matching transformer, one cable should run from the output of an 8 ohm maximum 25 watt amplifier to one ES-4T-LE speaker only, or from the output a 4 ohm maximum 50 watt amplifier to one ES-62T-LE speaker only. Wiring the speaker system in a series/parallel configuration may be acceptable depending upon the amplifier used, but that wiring method is not covered in this installation manual.

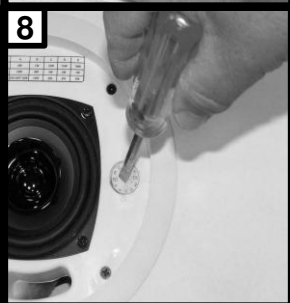

7 Push the rear of the speaker and the wiring through the hole in the ceiling and into the rough-in bridge and enclosure. Tighten the mounting ear screws with a Phillips screwdriver so the ears rotate away from the speaker body and clamp to the rough-in bridge and ceiling. **WARNING: Do not over-tighten the plastic dog ears or they can break.** As shipped from the factory, the dog ears can span a ceiling thickness of 1.25". The dog ears can be removed, rotated 180 degrees, and placed back on the tightening screw and they will then be capable of attaching to a ceiling thickness up to 2.125".



8 Using a flat blade screwdriver, set the transformer tap select switch on the desired position (see the tap chart on the face of the speaker). **Note: Do not use the 8Ω or 4Ω switch position when using the speaker level output from a 25V, 70V, or 100V amplifier.**

Note: If custom paint is not required, skip to step **11**.

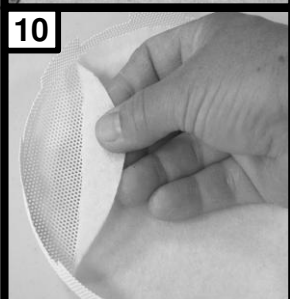

9 Use the plastic shipping protection cover as a paint shield to spray the front trim ring.

10 Carefully peel off the white scrim material before painting the grille. Spray paint the grille with a few light coats being very careful not to obstruct the holes in the grille with paint. After the paint on the grille is dry, replace the scrim using a light coat of all-purpose spray adhesive.

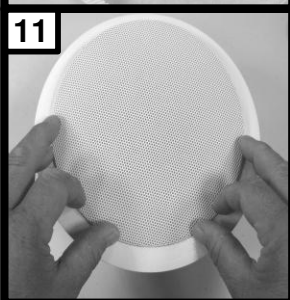

11 Press on the front grille until it is flush with the trim ring and the installation is complete.

UL Listing Note: The UL1480/CSA C22.2 Listing and UL2043 rating (suitable for use in plenum spaces), are valid only if the ES-4T-LE & ES-4-RIB & ES-8XD4 or the ES-62T-LE & ES-6-RIB & ES-CP84 are used together as a system. If any one of the three associated components is not used in the installation of the system, the UL Listing will not be valid.

Non-UL-Listed Infinite Baffle Applications.

It is possible to install the ES-4T-LE speaker system in a non-UL-Listed infinite baffle application (without an enclosure such as in a residential installation) as described below:

Lay-in tile ceiling: Use the ES-CR4 “C-Ring” (sold separately) and a pair of ES-BR tile bridge rails (sold separately).

Existing drywall ceiling: Use the ES-CR4 “C-ring” (recommended to support the cut-out hole edge in the drywall ceiling).

New drywall ceiling: Use the ES-4-RIB rough-in bridge (sold separately).

The ES-62T-LE speaker system can also be installed in a non-UL-Listed infinite baffle application (without an enclosure) using the ES-CR6, ES-BR, or ES-6-RIB. For more information on non-UL-Listed infinite baffle applications, call Lowell Customer Service.